

**Double A**  
Hydraulics



®

# series Q-03 relief valve



536 TOWNSHIP LINE ROAD  
FLUID TECHNOLOGY ANNEX  
BLUE BELL, PENNSYLVANIA 19422  
Tel: 215.643.0617  
Fax: 216.643.4017  
sales@doubleahydraulics.com  
www.doubleahydraulics.com

6100 psi, 30 Gpm max  
pilot operated spool type

## TECHNICAL DATA

Maximum operating pressure 6100 psi  
 Maximum Flow: 30 gpm  
 Maximum leakage: 6 in<sup>3</sup>/min at 90% of setting  
 Operating Temperature Range: -22F to 230F  
 Viscosity: 60-1800 SSU hydraulic oil with lubricating properties  
 Orientation: Optional  
 Installation Torque: 40-45 foot pounds  
 Weight: 0.43 pounds  
 Pressure on port 2 (tank port) is directly additive to the valve setting at a 1:1 ratio.  
 Steel construction  
 Zinc Plated

## PRESSURE DROP DATA

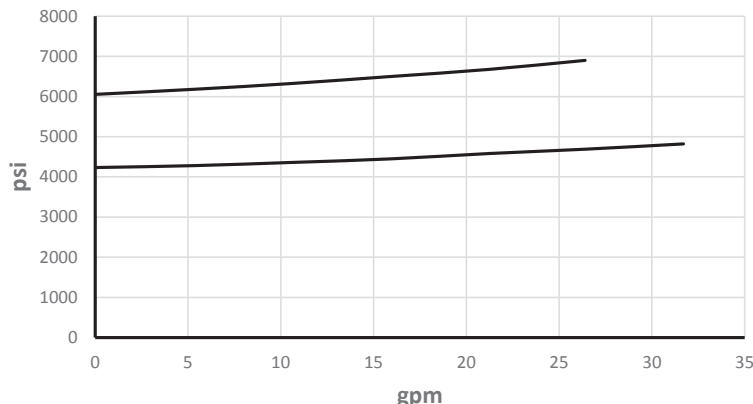

(Note: Curves shown at maximum setting for each spring)

## DIMENSIONS

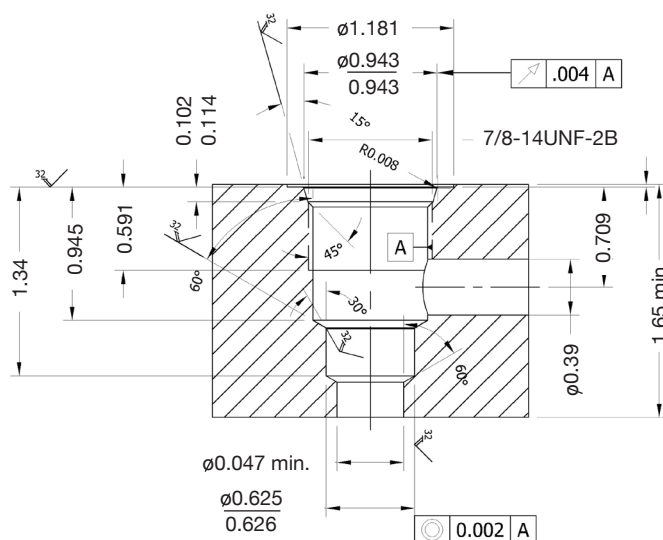
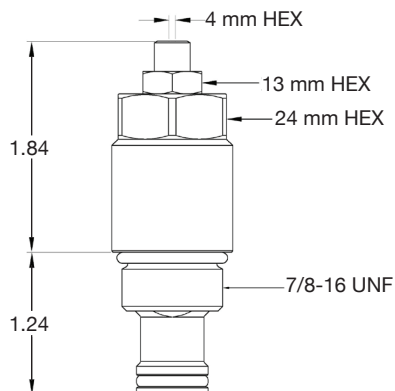

## ORDERING INFORMATION

### RVCP - S10 - N X - 2000

**TYPE**  
RVCP - PILOT OPERATED RELIEF VALVE

**CAVITY**  
SAE10

**SEALS**  
N - BUNA  
V - VITON

**VALVE SETTING**  
STANDARD SETTING  
1500, 2000, 2500, 3000, 4000, 5000 PSI

**ADJUSTMENT RANGE**  
X = 300 - 4100 PSI  
Z = 4100 - 6100 PSI  
(NON STANDARD RANGE)